

# THE OAKTON

The foyer leads to the two car garage and to the second and third floors.

The large living room and spacious dining room are connected, creating a comfortable environment for entertaining.

The kitchen has abundant counter space and is attached to the dining room, making it perfect for entertaining.

The spacious master bedroom has a large walk-in closet and separate master bath with dual-sink vanity, separate shower, and tub.

Nine foot ceilings throughout the lower and living levels.

2 bedrooms, 2 1/2 baths.

Included two-car garage.

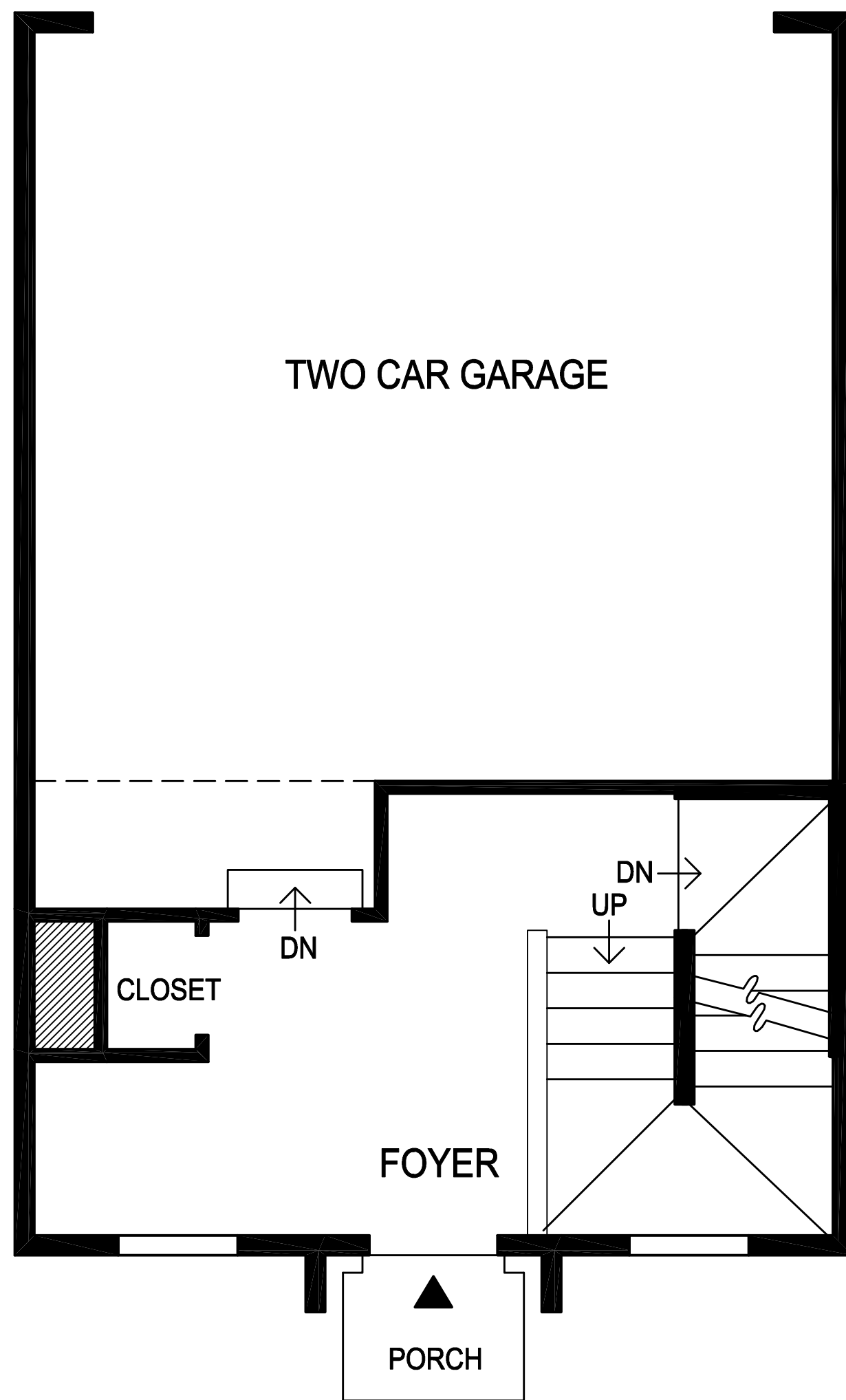

LOWER LEVEL

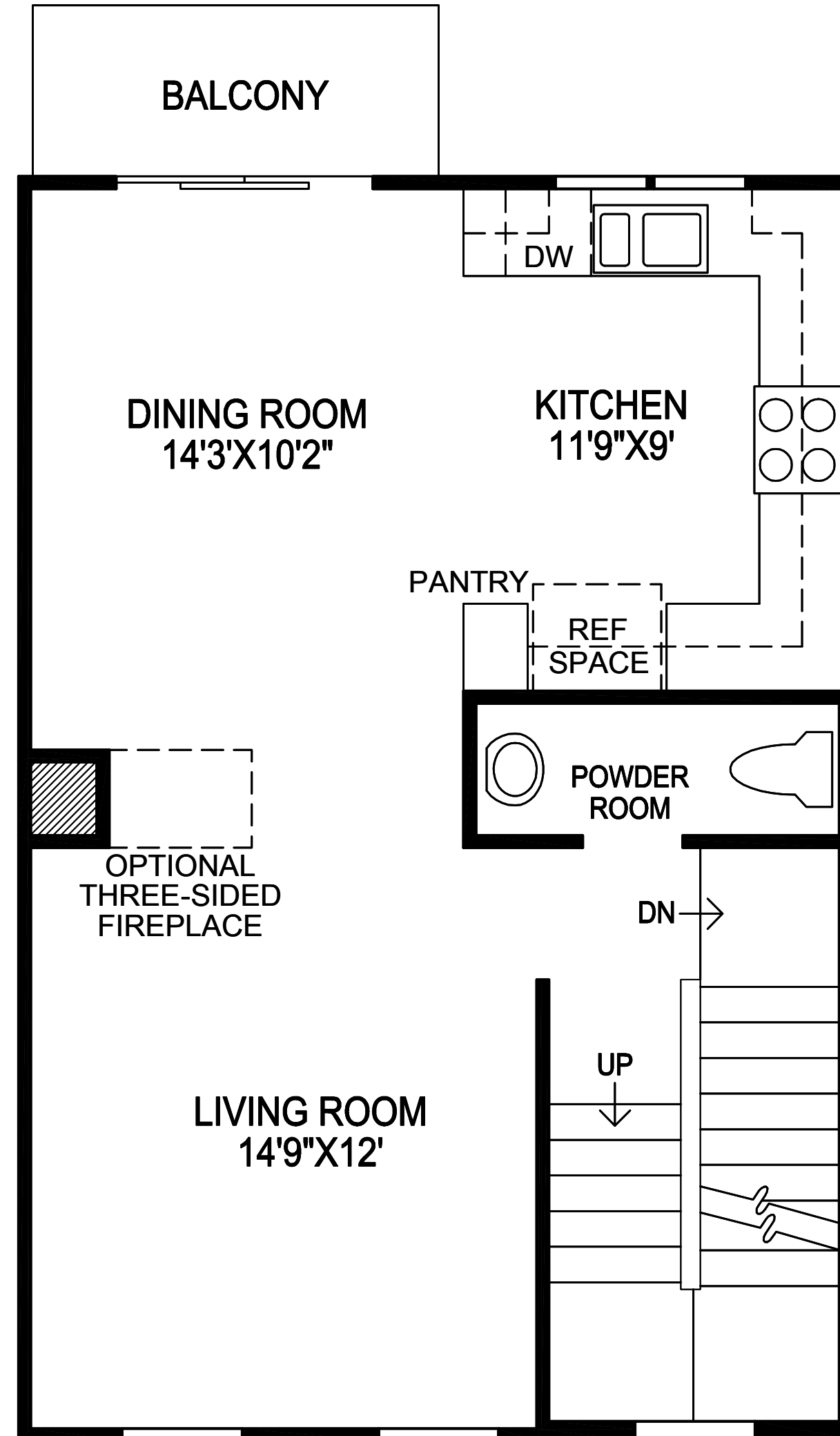

LIVING LEVEL

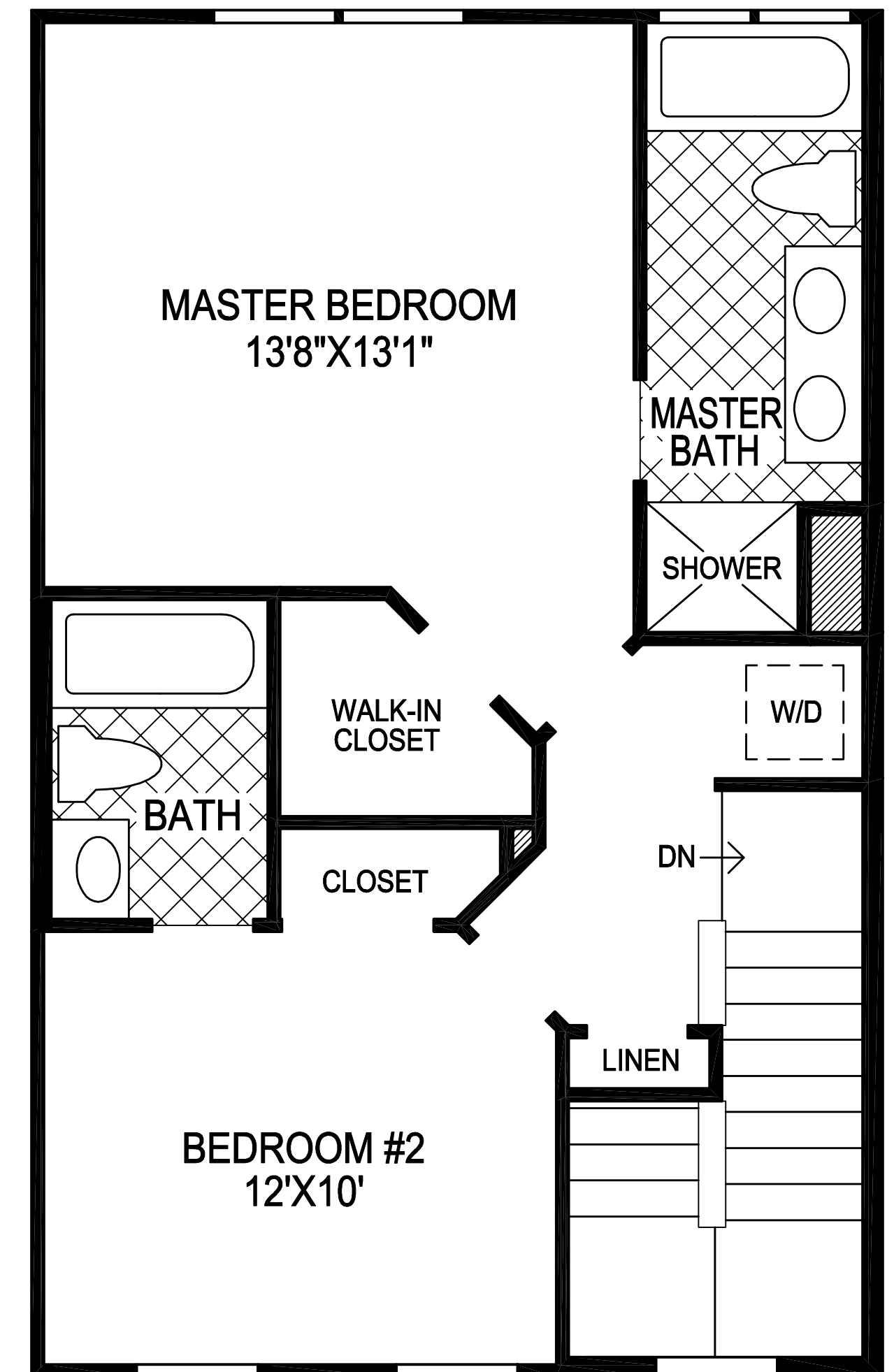

BEDROOM LEVEL

All dimensions are approximate, shown to the maximum dimensions of each room, and are subject to field variation. Dimensions should not be used to calculate room square footage. Some windows, exterior features, ceiling heights, and floor plans may vary with elevations. Features may also vary from community to community. Please consult a Sales Manager for details. Options purchased must be specified in Exhibit B.

(MASTER) 1027 ©2006 TOLL BROTHERS, INC. (OAKTON)